

REMOVABLE TRIM BOARD DETAIL - VINYL INSTALL PRIOR TO CLADDING

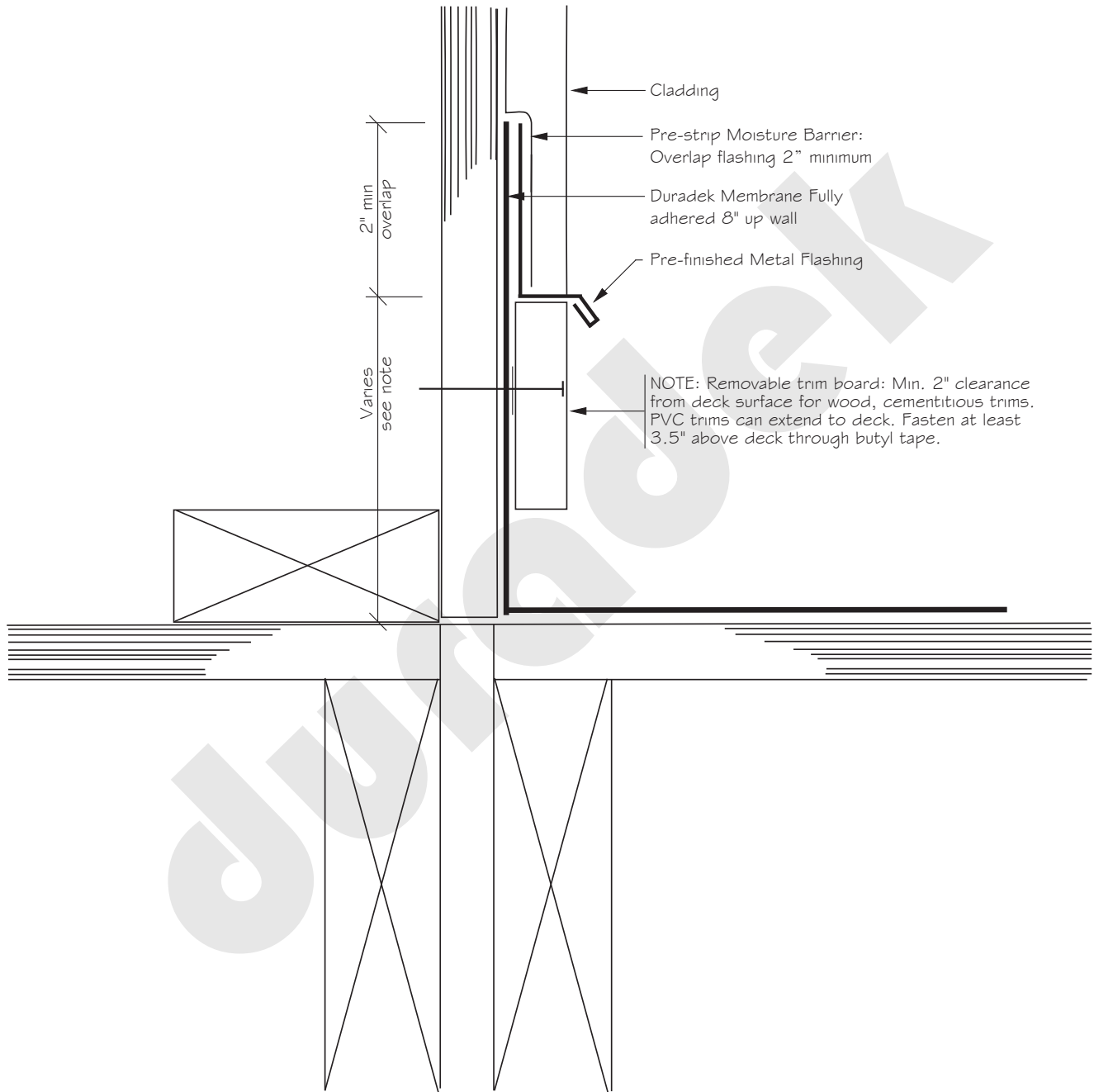

NOTE:

AS A SUPPLIER OF FINISHED PRODUCT ONLY, DURADEK DOES NOT ASSUME RESPONSIBILITY FOR ERRORS IN DESIGN, ENGINEERING, OR DIMENSIONS. THE ARCHITECT, ENGINEER, SPECIFIER, CONTRACTOR OR OWNERS' REPRESENTATIVE MUST VERIFY ALL DIMENSIONS, SIZES, AND SUITABILITY OF DETAILS, AND ARE IN ACCORDANCE WITH GOVERNING BUILDING CODES.

DURADEK LTD.

CANADA
UNITED STATES

Tel: (604) 591-5594
Tel: (816) 421-5830

Fax: (604) 591-3100
Fax: (816) 421-2924

SYSTEM:
ALL ASSEMBLIES

DATE: 25/28/08
REV. DATE: 22/12/20

DRAWING No:
IS-08 - A