

INSIDE PERIMETER DETAIL - 'L' TRIM

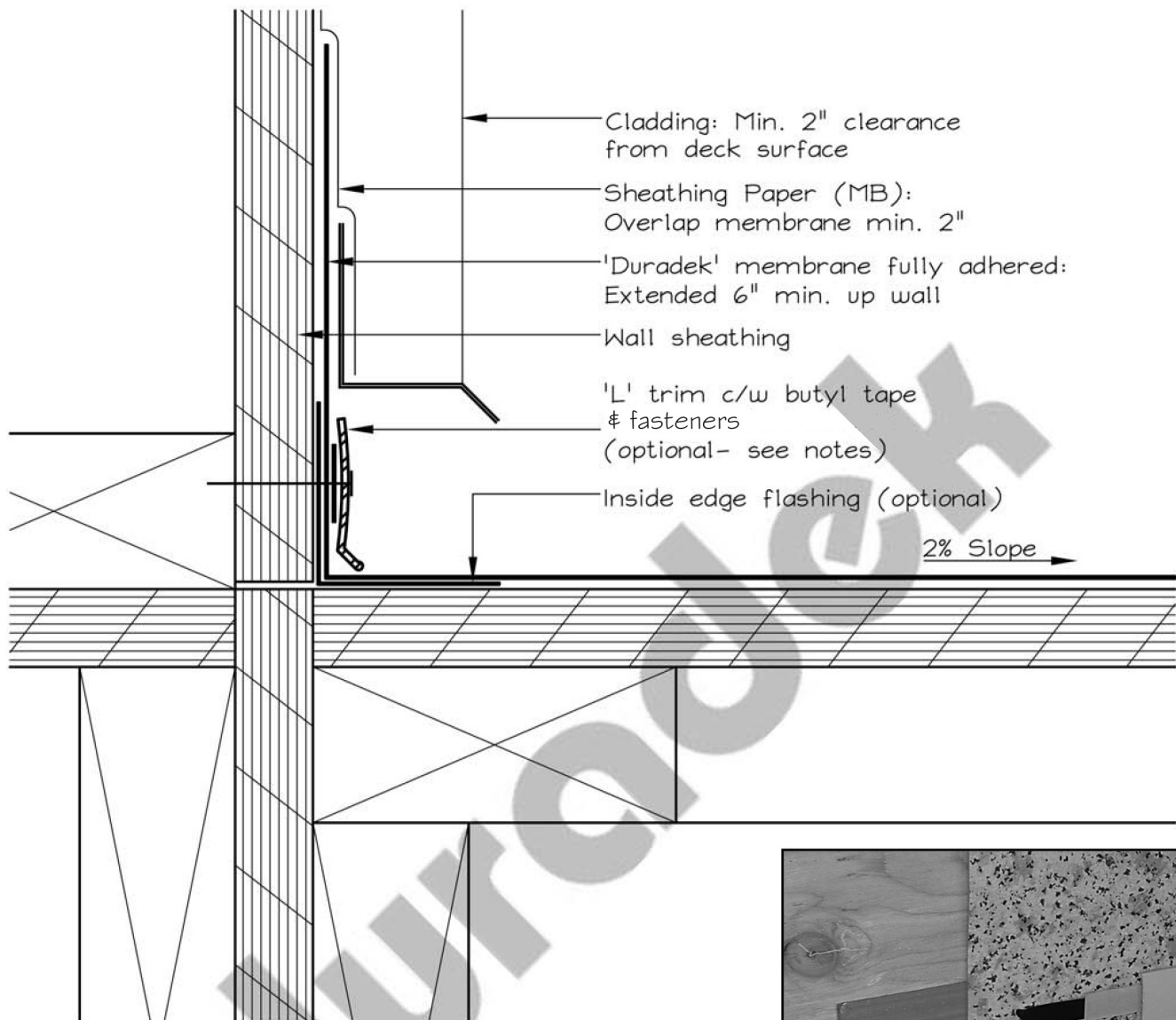

Note: Urethane caulking trowelled into corner not required if the July 25% dry bulb temperature does not exceed 29° C (84.2° F)

Fastener Options supplied by Duradek are
Color Coated Screws or Painted Ring Shank Nails

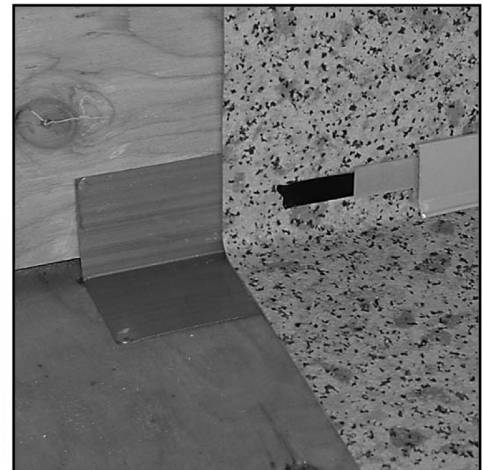

NOTE:

AS A SUPPLIER OF FINISHED PRODUCT ONLY, DURADEK DOES NOT ASSUME RESPONSIBILITY FOR ERRORS IN DESIGN, ENGINEERING, OR DIMENSIONS. THE ARCHITECT, ENGINEER, SPECIFIER, CONTRACTOR OR OWNERS' REPRESENTATIVE MUST VERIFY ALL DIMENSIONS, SIZES, AND SUITABILITY OF DETAILS, AND ARE IN ACCORDANCE WITH GOVERNING BUILDING CODES.

DURADEK LTD.

CANADA
UNITED STATES

Bus: (604) 591-5594
Bus: (816) 421-5830

Fax: (604) 591-3100
Fax: (816) 421-2924

SYSTEM:
ALL ASSEMBLIES

DATE: 31/08/04
REV. DATE: 10/04/19

DRAWING No.:
IS-01