

**INSIDE PERIMETER DETAIL: CONTACT ADHESIVE @ FIELD AREA OF MEMBRANE**

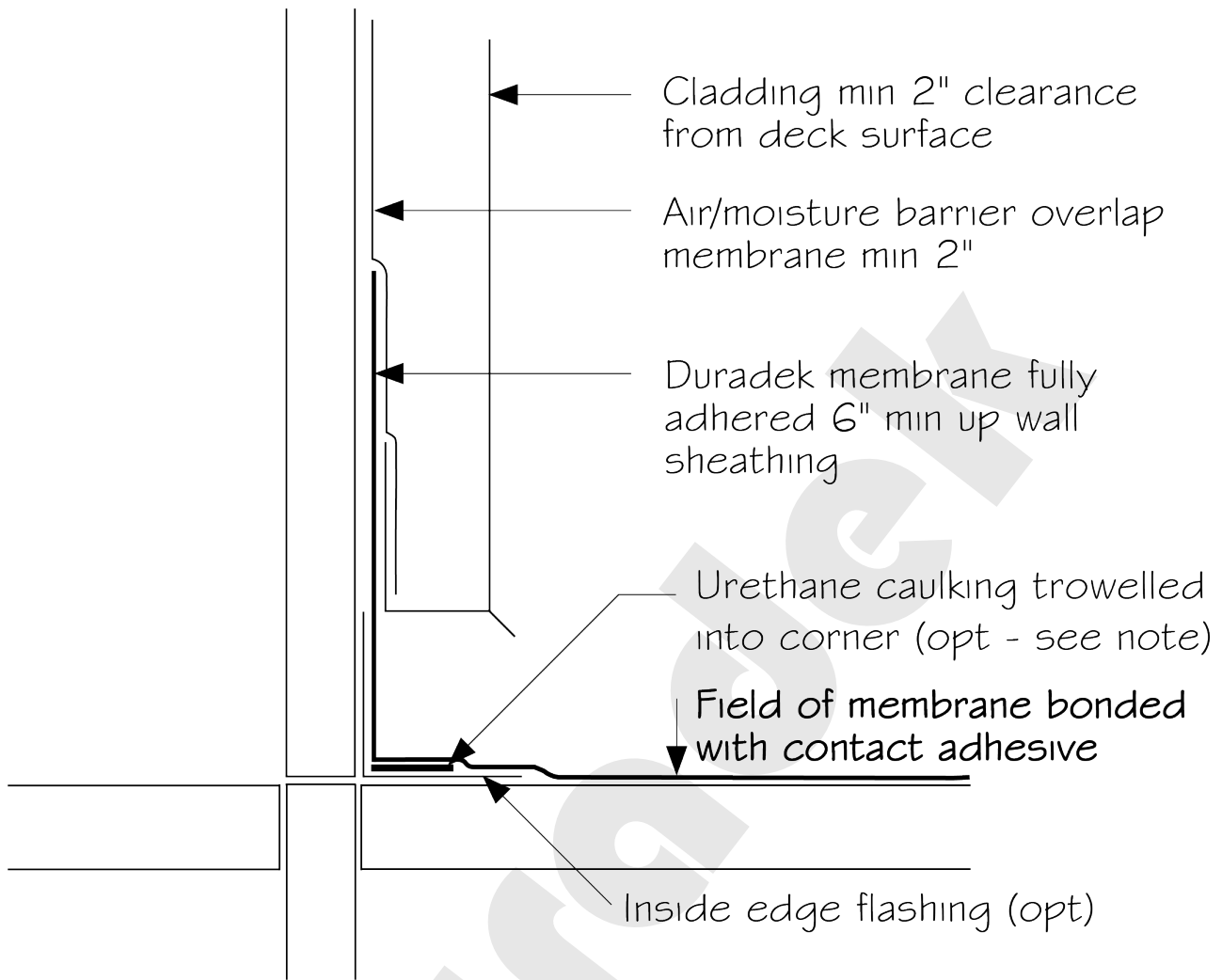

Note: Urethane caulking trowelled into corner not required if the July 25% dry bulb temperature does not exceed 29 C (84.2° F)

Fastener Options supplied by Duradek are Color Coated Screws or Painted Ring Shank Nails

**NOTE:** AS A SUPPLIER OF FINISHED PRODUCT ONLY, DURADEK DOES NOT ASSUME RESPONSIBILITY FOR ERRORS IN DESIGN, ENGINEERING, OR DIMENSIONS. THE ARCHITECT, ENGINEER, SPECIFIER, CONTRACTOR OR OWNERS' REPRESENTATIVE MUST VERIFY ALL DIMENSIONS, SIZES, AND SUITABILITY OF DETAILS, AND ARE IN ACCORDANCE WITH GOVERNING BUILDING CODES.

**DURADEK LTD.**

CANADA  
UNITED STATES

Bus: (604) 591-5594  
Bus: (816) 421-5830

Fax: (604) 591-3100  
Fax: (816) 421-2924

SYSTEM:  
ALL ASSEMBLIES

DATE: 13/03/19  
REV. DATE:

DRAWING No.:  
IS-01-ALT 'B'